

ED VECTOR+, V1+, V2+ (RS)

Recessed - Direct Distribution

Safety & Warnings:

Risk of fire and electrical shock. Fixture must be installed by a qualified electrician only in accordance with national local building and electrical codes. Disconnect power at electrical panel before servicing. 

General contractor is responsible for the installation of appropriate anchors to support the load of the fixture at positions detailed in the installation manual. Installation of such anchors or other support systems must be completed in accordance with applicable building/installation code.

Installation Instructions

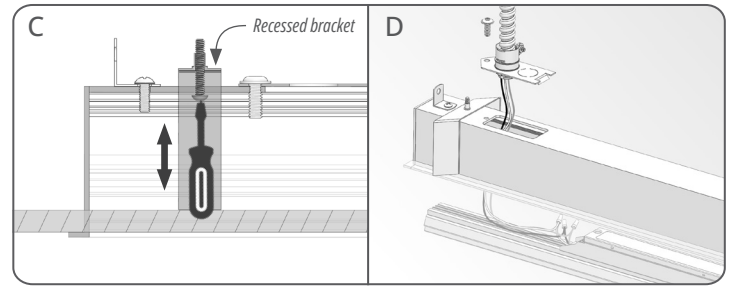

- Open access power plate (Fig. B&D) and connect 1/2" conduit. Reattach access plate and fasten.
- Raise fixture through the opening in the ceiling.
- Twist recessed brackets (Fig. B) until resting on ceiling.
- Adjust height by turning the screw from underneath fixture (Fig. C), until trim is up against ceiling.
- Connect power from access plate and fixture power on LED plate (Fig. D) according to Electrical national code.
- Re-install LED plate and secure with screw. Re-install lens by snapping into extrusion.
- Turn on power and test.

For Continuous Runs:

* All continuous run sections come with pre-installed connector bracket.

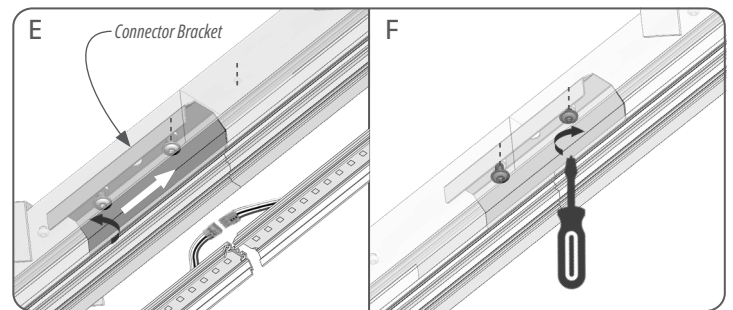

- Arrange extrusion sections according to label located on fixture.
- Install extrusions by repeating steps 2 - 7.
- Loosen screws and slide connector bracket in between sections (Fig. E).
- Tighten against pre-located blind holes (Fig. F).
- Connect power and dimming connectors (Fig. E).
- Repeat step 9 for multiple sections. If you have multiple power feeds, repeat steps 4 - 8.
- When finished installation, turn on power and test.

Mounting Locations

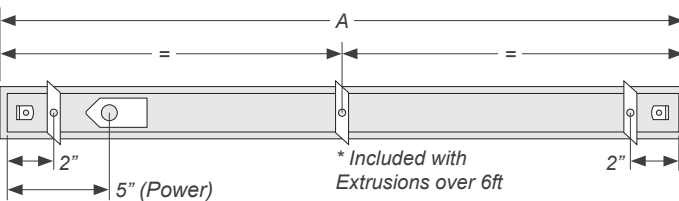

	1ft	2ft	3ft	4ft	5ft	6ft	7ft	8ft
Extrusion Length (A)	11.34"	22.34"	33.34"	48.22"	59.22"	71.97"	82.97"	95.72"

Fixture Sizes

	Cutout Width (W1)	Trim Width (W2)	Max. Width (W3)	Fixture Height (H)
Vector+	2.00"	2.56"	3.87"	2.75"
Vector 1+	2.60"	3.00"	4.18"	3.25"
Vector 2+	3.60"	4.00"	4.85"	4.00"

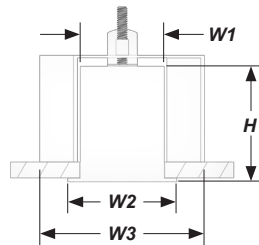

* For continuous runs refer to shop drawing

Steps:

- Turn off the power.
- Remove lens with a flat-head screw driver. (Fig. A1) Careful not to scratch extrusion. (Do not remove Endcaps)
- Unscrew LED plate, remove using flathead screwdriver, and disconnect power from driver (Fig. A2).

