

FEATURES:

- ✓ Architectural linear luminaire with direct or direct/indirect distribution.
- ✓ Light source: LED board or LED strip.
- ✓ Even illumination is provided by a variety of high-efficiency optic lenses.
- ✓ Available for row mounted installations in various lengths.
- ✓ Suitable for surface, suspended, recessed or wall mounted installations.
- ✓ Extruded aluminum body comes with a standard black or white finish.
- ✓ Also available with various custom color options.
- ✓ LED strips are rated for 60,000 hrs. L80 with +90 CRI.
- ✓ Has a proven record in office, commercial and retail installations.
- ✓ Custom modifications are available.
- ✓ ED luminaires are certified to CSA and UL standards.

reinventlight

SPECIFICATION:

ED VECTOR+ — — — — — — — — —

Enter the Product Code into the boxes above.

SIZE

_____ ft
1-8 ft
Continuous Run
(0.5 ft Increments)

SOURCE

- ☐ 5 W/ft
- ☐ 7 W/ft
- ☐ 10 W/ft

RADIANCE

- ☐ DD - Direct
- ☐ ID - Indirect only
- ☐ UD - Uneven¹

1. Available in sizes 4 ft and up.

VOLTAGE

- ☐ UNV - 120/277V
- ☐ 347V¹

1. Verify availability.

DRIVER

- ☐ ST - On/Off
- ☐ DL - 0-10V Dim (1%)
- ☐ DLO - 0-10V Dim (to Off)
- ☐ DL2 - 0-10V Dim (TW)
- ☐ DLA - 0-10V Dim (Aux)
- ☐ DA4 - DALI D4i
- ☐ CV - Constant Voltage (RGBW)
- ☐

Specify dimming protocol.

MOUNTING

- ☐ S6B - 6ft Cord BK¹
- ☐ S6W - 6ft Cord WH¹
- ☐ S ft²
- ☐ WM - Wall Mount
- ☐ WF - Wall Flush
- ☐ SF - Surface Mount
- ☐ RT - Recessed Trimless

1. Canopy match the Cord color.
2. Specify Suspension length/color.

- ☐ OP - Opal
- ☐ AS - Asymmetric
- ☐ PR - Prismatic

FINISH

- ☐ BK - Black¹
- ☐ WH - White²
- ☐ CF/RAL

1. RAL 9005
2. RAL 9016
Specify required RAL number.

CCT

- ☐ 30K - 3000 Kelvin/90CRI
- ☐ 35K - 3500 Kelvin/90CRI
- ☐ 40K - 4000 Kelvin/90CRI
- ☐ RGBW¹
- ☐ TW - Tunable White (27K-65K)²
- ☐

1. Available with DMX or CB.
2. Available with DL2, DA4 or CB.
Specify required CCT.

OPTIONS

- ☐ No Options¹
- ☐ EM - Emergency Battery Pack²
- ☐ DC - Dual Circuit³
- ☐ EC - Emergency Circuit
- ☐ DR - Damp Rated
- ☐ CB - Casambi Bluetooth(TW, RGBW)⁴
- ☐ DMX - DMX (RGBW)
- ☐ JD - JDRF Autonomy Sensor (DA4)⁴
- ☐ DOS - Daylight & Occupancy Sensor (DLA)⁴
- ☐ AWN - Athena Wireless Node (DLA)⁴

1. Leave empty.
2. Battery Pack per 4 ft section.
3. Control Downlight/Uplight separately.
4. Available in sizes 4 ft and up.

LUMEN OUTPUT W/ft:

Watts	30K	35K	40K
5 W	515 lm	525 lm	535 lm
7 W	720 lm	735 lm	750 lm
10 W	1030 lm	1050 lm	1080 lm



Project:

Type:

SIZE:



Size	L
1 ft	11.50 in
2 ft	24.25 in
3 ft	35.25 in
4 ft	48.00 in
5 ft	59.00 in
6 ft	71.75 in
7 ft	82.75 in
8 ft	95.50 in

L - Linear extrusion length only.
 Total length with Endcaps = L + (2 x 0.11)

CONTINUOUS RUN:



Continuous Run suspension dimensions
 L1 = L - 2.0 in

RADIANCE:

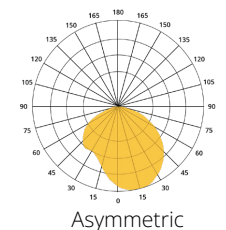
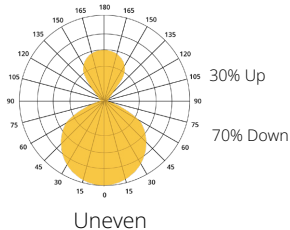
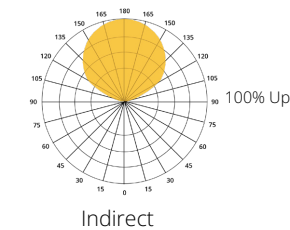
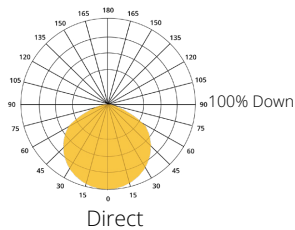

MOUNTING:

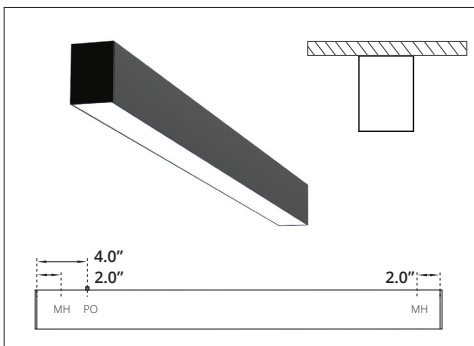

SURFACE MOUNT

MH - Mounting Hole
 PO - Power Opening

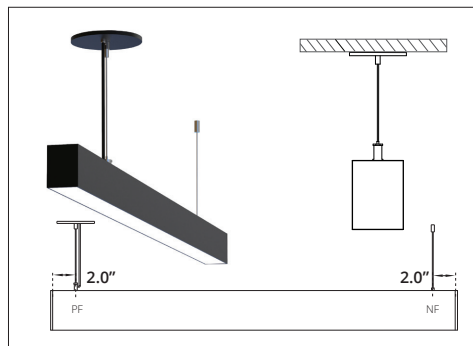

SUSPENDED

PF - Power Feed
 NF - Non Power Feed

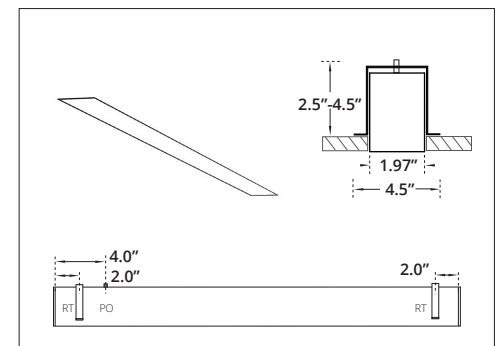

RECESSED TRIMLESS

RT - Recessed Trimless Bracket
 PO - Power Opening
 Cutout Dimensions = Total Length x Width of Extrusion.

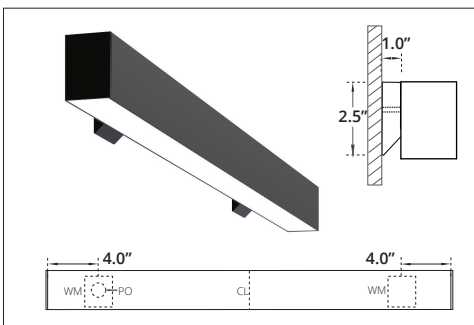

WALL MOUNT

PO - Power Opening
 WM - Wall Mount Bracket
 1-3 ft, single Wall Mount Bracket with Power Opening in the centre.

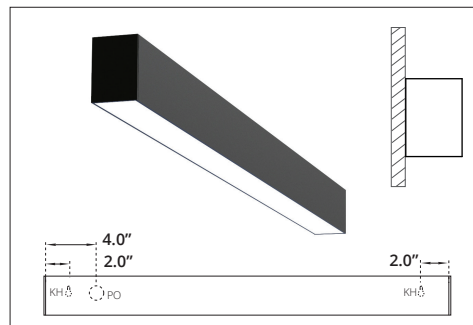

WALL FLUSH

KH - Key Hole
 PO - Power Opening

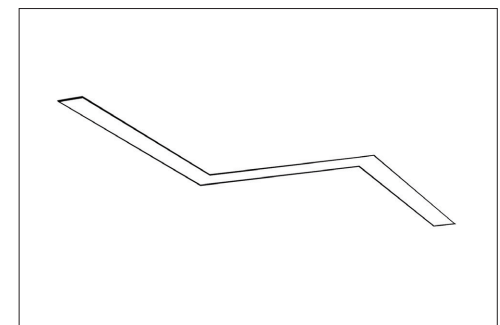

VARIABLE ANGLE

60°, 90°, 120°, 135° or Custom.