

### FEATURES:

- ✓ Architectural linear luminaire with direct or direct/indirect distribution.
- ✓ Light source: LED board or LED strip.
- ✓ Even illumination is provided by a high efficiency opal lens.
- ✓ Available for row-mounted installations in various lengths.
- ✓ Suitable for surface, suspended, recessed or wall mounted installations.
- ✓ Extruded aluminum body comes with a standard black or white finish.
- ✓ Also available with various custom color options.
- ✓ LED strips are rated for 60,000 hrs. L80 with +90 CRI.
- ✓ Has a proven record in office, commercial, and retail installations.
- ✓ Custom modifications are available.
- ✓ ED luminaires are certified to CSA and UL standards.

reinventlight

### SPECIFICATION:

**ED VECTOR1+**

Enter the Product Code into the boxes above.

#### SIZE

\_\_\_\_\_ Feet\*

\*1-8 Feet  
Continuous Run  
(0.5 Feet Increments)

#### SOURCE

- ☐ 5W/FT LED  
☐ 7W/FT LED  
☐ 10W/FT LED

#### RADIANCE

- ☐ DD - Direct (100%Down)  
☐ UD - Uneven (70%Down/30%Up)\*\*

\*Light distribution.  
\*\*Not available for sizes shorter than 4 Feet.

#### VOLTAGE

- ☐ 120V  
☐ 277V  
☐ 347V\*

\*Not available for all configurations.

#### DRIVER

- ☐ ST - On/Off  
☐ DL - 0-10V Dim (1%)  
☐ DLO - 0-10V Dim (to Off)  
☐ DL2 - 0-10V Dim (TW)  
☐ DA4 - DALI D4i  
☐ DMX - DMX RGBW  
☐ EM - Emergency Driver\*  
☐  \*\*

\*Battery Pack min. 4 Feet section.  
\*\*Specify dimming protocol.

#### MOUNTING

- ☐ S6W - 6Ft Cord WH\*  
☐ S6B - 6Ft Cord BK\*  
☐ S  Feet\*\*  
☐ WM - Wall Mount  
☐ WF - Wall Flush  
☐ SF - Surface Mount  
☐ RT - Recessed Trimless

\*Canopy will match the Cord color.  
\*\*Specify Suspension length and color.

#### LENS

- ☐ OP - Opal

#### FINISH

- ☐ BK - Black\*  
☐ WH - White\*\*  
☐ CF/RAL  \*\*\*

\*RAL 9005  
\*\*RAL 9016  
\*\*\*Specify required RAL number.

#### CCT

- ☐ 30K - 3000 Kelvin/90CRI  
☐ 35K - 3500 Kelvin/90CRI  
☐ 40K - 4000 Kelvin/90CRI  
☐ RGBW  
☐ TW - Tunable White\*  
(2700K-6500K)  
☐  \*\*

\*Available with 0-10V, Dali or Bluetooth controls.  
\*\*Specify required CCT.

#### OPTIONS

- ☐ No Options\*  
☐ DR - Damp Rated  
☐ DC - Dual Circuit\*\*  
☐ CB - Casambi/Bluetooth  
☐ JD - JDRF Autonomy Sensor  
☐ DOS - Daylight & Occupancy Sensor  
☐  \*\*\*

\*Leave empty.  
\*\*Control Downlight/Uplight separately.  
\*\*\*Specify required option.

### LUMEN OUTPUT W/Ft:

Watts	30K	35K	40K
5W	515 lm	525 lm	535 lm
7W	720 lm	735 lm	750 lm
10W	1030lm	1050 lm	1080 lm



Project:

Type:

### SIZE:

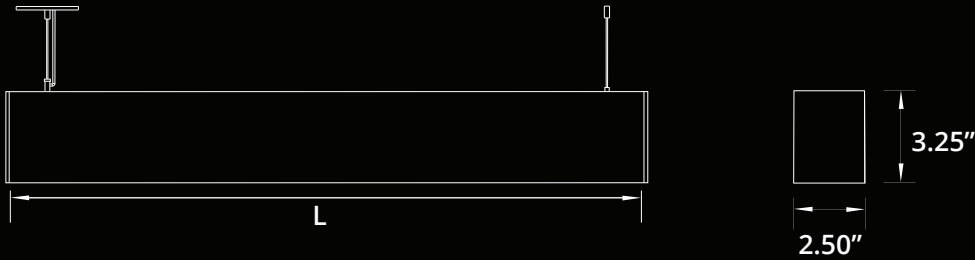

Size	L (LENGTH)
1 Feet	11.50 Inch
2 Feet	24.25 Inch
3 Feet	35.25 Inch
4 Feet	48.00 Inch
5 Feet	59.00 Inch
6 Feet	71.75 Inch
7 Feet	82.75 Inch
8 Feet	95.50 Inch

Total length with endcaps = L + 0.22"

### CONTINUOUS RUN:



### RADIANCE:

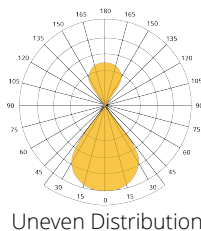
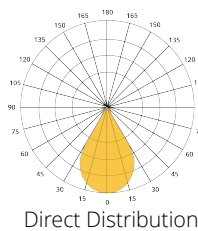

### MOUNTING:

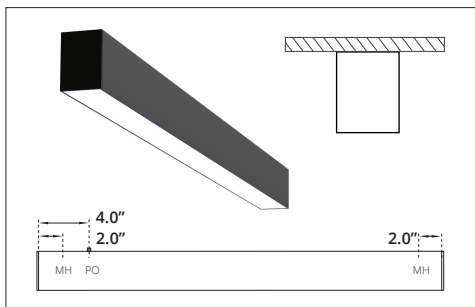

#### SURFACE MOUNT

MH - Mounting Hole  
PO - Power Opening

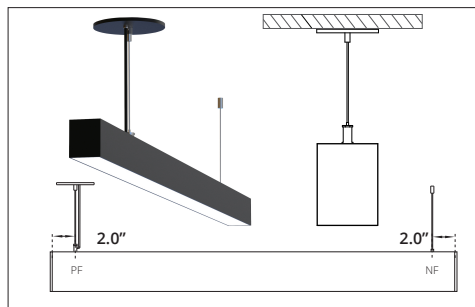

#### SUSPENDED

PF - Power Feed  
NF - Non Power Feed

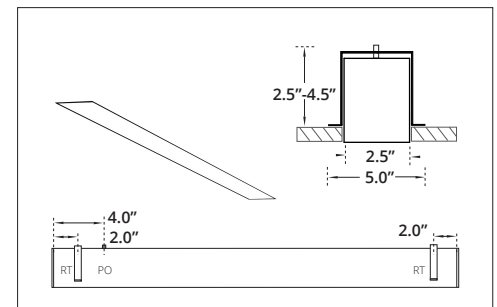

#### RECESSED TRIMLESS

RT - Recessed Trimless Bracket  
PO - Power Opening  
\*Cutout Dimensions = Total Length x Width of Extrusion.

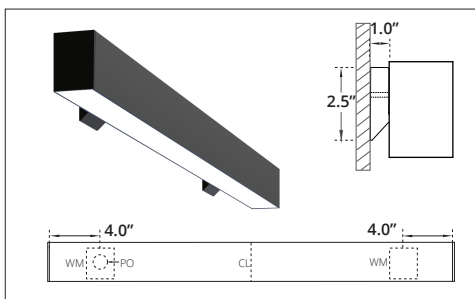

#### WALL MOUNT

PO - Power Opening  
WM - Wall Mount Bracket  
\*1-3 Feet, single Wall Mount Bracket with Power Opening in the centre.

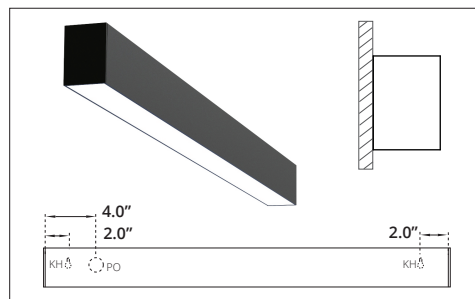

#### WALL FLUSH

KH - Key Hole  
PO - Power Opening

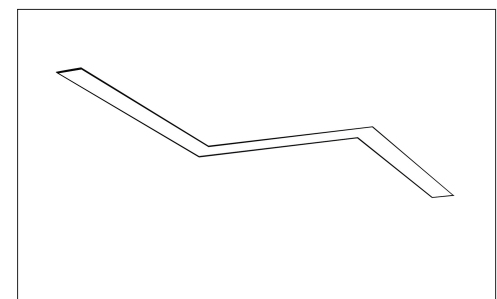

#### VARIABLE ANGLE

60°, 90°, 120°, 135° or Custom.