

### FEATURES:

- ✓ Architectural linear luminaire with direct or direct/indirect distribution.
- ✓ Light source: LED board or LED strip.
- ✓ Even illumination is provided by high efficiency opal lenses.
- ✓ Available for row-mounted installations in various lengths.
- ✓ Suitable for surface, suspended, recessed or wall mounted installations.
- ✓ Extruded aluminum body comes with a standard black or white finish.
- ✓ Also available with various custom color options.
- ✓ LED strips are rated for 60,000 hrs. L80 with +90 CRI.
- ✓ Has a proven record in office, commercial and retail installations.
- ✓ Custom modifications are available.
- ✓ ED luminaires are certified to CSA and UL standards.

reinventlight

### SPECIFICATION:

ED VECTOR2+  —  —  —  —  —  —  —  —  —  —

Enter the Product Code into the boxes above.

#### SIZE

\_\_\_\_\_ ft  
1-8 ft  
Continuous Run  
(0.5 ft Increments)

#### SOURCE

- ☐ 5 W/ft
- ☐ 7 W/ft
- ☐ 10 W/ft

#### RADIANCE

- ☐ DD - Direct
  - ☐ UD - Uneven<sup>1</sup>
1. Available in sizes 4 ft and up.

#### VOLTAGE

- ☐ UNV - 120/277V
  - ☐ 347V<sup>1</sup>
1. Verify availability.

#### DRIVER

- ☐ ST - On/Off
  - ☐ DL - 0-10V Dim (1%)
  - ☐ DLO - 0-10V Dim (to Off)
  - ☐ DL2 - 0-10V Dim (TW)
  - ☐ DLA - 0-10V Dim (Aux)
  - ☐ DA4 - DALI D4i
  - ☐ CV - Constant Voltage (RGBW)
  - ☐
- Specify dimming protocol.

#### MOUNTING

- ☐ S6B - 6 ft Cord BK<sup>1</sup>
- ☐ S6W - 6 ft Cord WH<sup>1</sup>
- ☐ S  ft<sup>2</sup>
- ☐ WM - Wall Mount
- ☐ WF - Wall Flush
- ☐ SF - Surface Mount
- ☐ RT - Recessed Trimless

1. Canopy match the Cord color.  
2. Specify Suspension length/color.

#### LENS

- ☐ OP - Opal
- ☐ OR - Opal Regressed

#### FINISH

- ☐ BK - Black<sup>1</sup>
  - ☐ WH - White<sup>2</sup>
  - ☐ CF/RAL
1. RAL 9005  
2. RAL 9016  
Specify required RAL number.

#### CCT

- ☐ 30K - 3000 Kelvin/90CRI
- ☐ 35K - 3500 Kelvin/90CRI
- ☐ 40K - 4000 Kelvin/90CRI
- ☐ RGBW<sup>1</sup>
- ☐ TW - Tunable White (27K-65K)<sup>2</sup>
- ☐

1. Available with DMX or CB.  
2. Available with DL2, DA4 or CB.  
Specify required CCT.

#### OPTIONS

- ☐ No Options<sup>1</sup>
- ☐ EM - Emergency Battery Pack<sup>2</sup>
- ☐ DC - Dual Circuit<sup>3</sup>
- ☐ EC - Emergency Circuit
- ☐ DR - Damp Rated
- ☐ CB - Casambi Bluetooth(TW, RGBW)<sup>4</sup>
- ☐ DMX - DMX (RGBW)
- ☐ JD - JDRF Autonomy Sensor (DA4)<sup>4</sup>
- ☐ DOS - Daylight & Occupancy Sensor (DLA)<sup>4</sup>
- ☐ AWN - Athena Wireless Node (DLA)<sup>4</sup>

1. Leave empty.  
2. Battery Pack per 4 ft section.  
3. Control Downlight/Uplight separately.  
4. Available in sizes 4 ft and up.

### LUMEN OUTPUT W/ft:

Watts	30K	35K	40K
5 W	515 lm	525 lm	535 lm
7 W	720 lm	735 lm	750 lm
10 W	1030 lm	1050 lm	1080 lm



Project:

Type:

## SIZE:



Size	L
1 ft	11.50 in
2 ft	24.25 in
3 ft	35.25 in
4 ft	48.00 in
5 ft	59.00 in
6 ft	71.75 in
7 ft	82.75 in
8 ft	95.50 in

L - Linear extrusion length only.  
 Total length with Endcaps = L + (2 x 0.11)

## CONTINUOUS RUN:



Continuous Run suspension dimensions  
 $L1 = L - 2.0$  in

## RADIANCE:

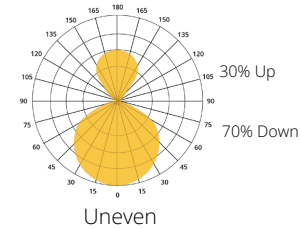
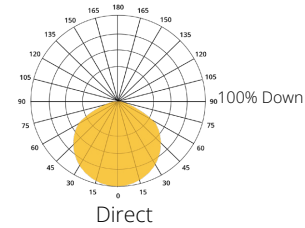

## MOUNTING:

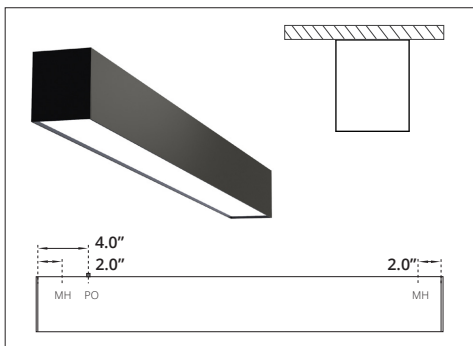

### SURFACE MOUNT

MH - Mounting Hole  
 PO - Power Opening

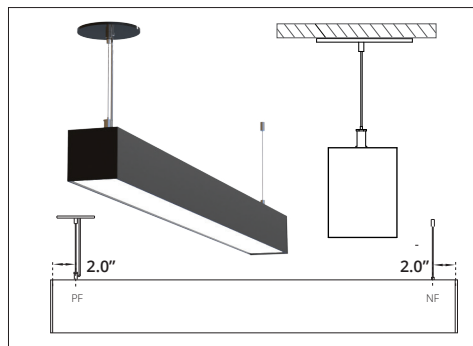

### SUSPENDED

PF - Power Feed  
 NF - Non Power Feed

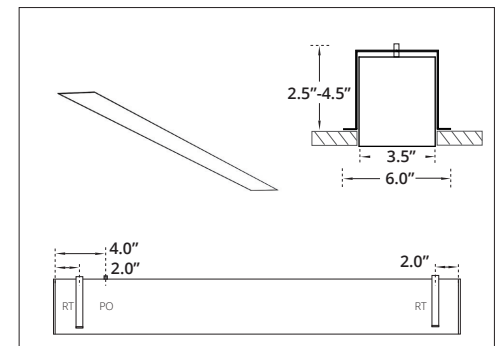

### RECESSED TRIMLESS

RT - Recessed Trimless Bracket  
 PO - Power Opening  
 Cutout Dimensions = Total Length x Width of Extrusion.

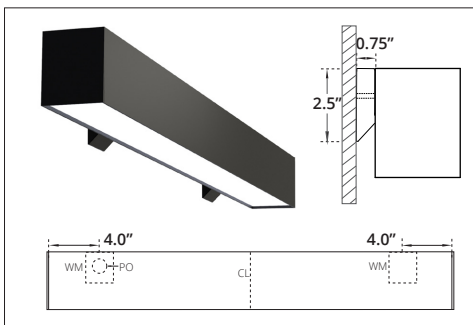

### WALL MOUNT

PO - Power Opening  
 WM - Wall Mount Bracket  
 1-3 ft, single Wall Mount Bracket with Power Opening in the centre.

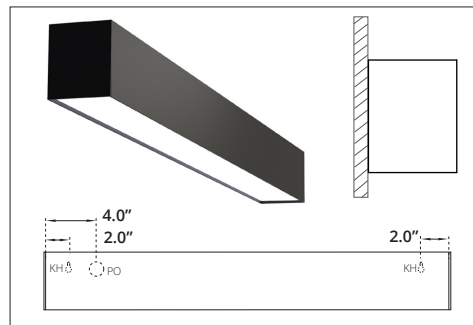

### WALL FLUSH

KH - Key Hole  
 PO - Power Opening

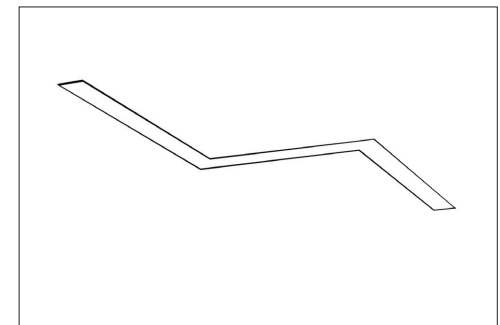

### VARIABLE ANGLE

60°, 90°, 120°, 135° or Custom.